

Morse Taper Sleeve

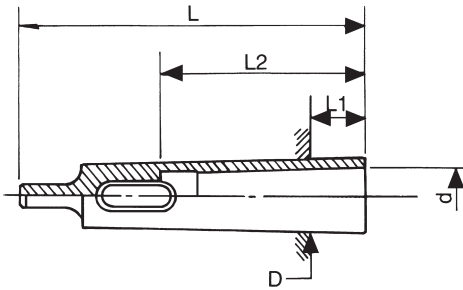

ORDER NO.	I.D.xO.D.	D	d	L	l1	l2	WEIGHT (kg)	CODE NO.
VQ-101	MT2xMT3	23.825	17.780	112	18	67	0.2	3210-001
VQ-102	MT2xMT4	31.267	17.780	124	6.5	67	0.5	3210-002
VQ-103	MT2xMT5	44.399	17.780	156	6.5	67	1.4	3210-003
VQ-104	MT2xMT6						4.13	3210-004
VQ-105	MT3xMT4	31.267	23.825	140	22.5	84	0.4	3210-005
VQ-106	MT3xMT5	44.399	23.825	156	6.5	84	1.3	3210-006
VQ-107	MT3xMT6	63.348	23.825	218	8	84	4	3210-007
VQ-108	MT4xMT5	44.399	31.267	171	21.5	107	1	3210-008
VQ-109	MT4xMT6	63.348	31.267	218	8	107	3.7	3210-009
VQ-110	MT5xMT6	63.348	44.399	218	8	133	2.9	3210-010
VQ-100	MT1xMT3	23.825	12.065	100	6	55	0.2	3210-011
VQ-100-1	MT1xMT2	17.780	12.065	89	14	55	0.22	3210-012
VQ-100-2	MT1xMT4	31.267	12.065	124	6.5	55	0.89	3210-013
VQ-100-3	MT1xMT5	44.399	12.065	156	7	55	1.33	3210-014



Morse Taper Extension Sockets

MORSE TAPER EXTENSION SOCKETS

- For adapting tools with morse taper shanks to machine having smaller morse taper spindle or for adapting tools with morse taper shanks to machine having the same or larger morse taper spindle.
- Hardened and ground throughout.

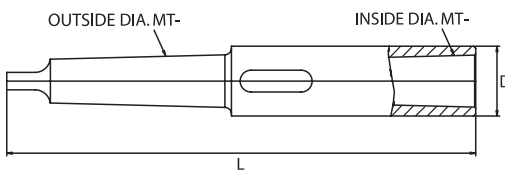

ORDER NO.	I.D.xO.D.	D	L	WEIGHT (kg)	CODE NO.
VQ-111-3	MT1xMT2	18.2	160	0.28	3210-018
VQ-111-1	MT1xMT3	20.2	175	0.4	3210-019
VQ-111-2	MT1xMT4	20.2	204	0.35	3210-020
VQ-112	MT2xMT2	24.2	175	0.35	3210-021
VQ-112-1	MT2xMT3	24.2	194	0.5	3210-022
VQ-112-2	MT2xMT4	24.2	219	0.9	3210-022A
VQ-112-3	MT2xMT5	24.2	254	1.85	3210-022B
VQ-113	MT3xMT2	32.2	196	0.56	3210-023
VQ-114	MT3xMT3	32.2	215	0.7	3210-024
VQ-115	MT3xMT4	32.2	240	1.1	3210-025
VQ-115-1	MT3xMT5	32.2	275	2.1	3210-025A
VQ-115-2	MT4xMT2	45.2	221	1.25	3210-026A
VQ-116	MT4xMT3	45.2	240	1.4	3210-026
VQ-117	MT4xMT4	45.2	265	1.7	3210-027
VQ-118	MT4xMT5	45.2	300	2.7	3210-028
VQ-119-1	MT5xMT3	63.2	275	3	3210-029A
VQ-119	MT5xMT4	63.2	300	3.25	3210-029
VQ-120	MT5xMT5	63.2	335	4.2	3210-030

R8 With Morse Taper Sleeve

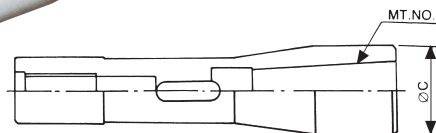
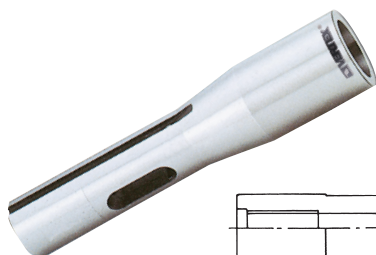

ORDER NO.	SHANK	SIZE	MT NO.	WEIGHT (kg)	CODE NO.
VQ-121	R8	R8-MT1	MT1	0.36	3211-003
VQ-122	R8	R8-MT2	MT2	0.4	3211-001
VQ-123	R8	R8-MT3	MT3	0.5	3211-002

